

Alpine Line

NEWSLETTER

ALLEGHENY CHAPTER NORTH AMERICAN ROCK GARDEN SOCIETY

4TH QUARTER 2025



© Kevin Kelly

Kevin Kelly's Crevice Garden



In this Issue



2025 Meeting Schedule



Facebook and Instagram



Aviary Rock Garden Update



Events and Photos



New Members Introduction



Focus on



Tell Us About It- List of deer resistant plants from Rutgers Extension Service



Message from the Chair



Leslie Kaplan speaks to the membership on plans and happenings.



**HAVE SOMETHING UNUSUAL
GROWING IN YOUR
GARDEN???**
TELL US ABOUT IT!

**PLEASE SHARE YOUR
OBSERVATIONS FOR
CORRECTIONS,
IMPROVEMENTS AND
THINGS YOU'D LIKE TO
SEE MORE OF IN THIS
NEWSLETTER - AND
BEYOND.**



Upcoming Meetings at locations listed. This schedule is current plan. Changes to schedule will be updated in newsletters or email.

NOVEMBER 9, 2025 – 2PM

Annual Awards Banquet/Highlights from Members Gardens. Send pictures and PowerPoints
Location: St. Joseph Church

OCTOBER 19, 2025 – PRESENTATIONS BY JULIA CORDEN THE GARDENS OF SCOTLAND & ALPINES AROUND THE WORLD



Julia Corden trained in horticulture at the Royal Horticultural Society Wisley and Royal Botanical Garden Edinburgh. She has judged at the Chelsea Flower Show and served on RHS Committees. A past president of the Scottish

rock
Garden
Club,

Julia is also a freelance botanical tour guide for Brightwater Holidays. She has led tours to Switzerland, Greece, Costa Rica, Chile, South Africa, Japan and New Zealand, as well as guided trips for the Alpine Garden Society, Scottish Rock Garden Club and the Royal Horticulture Society.



Meeting locations:

West View HUB
435 Perry Hwy
West View, PA 15229

St. Joseph Church
342 Dorseyville Rd
Pittsburgh, PA 15238

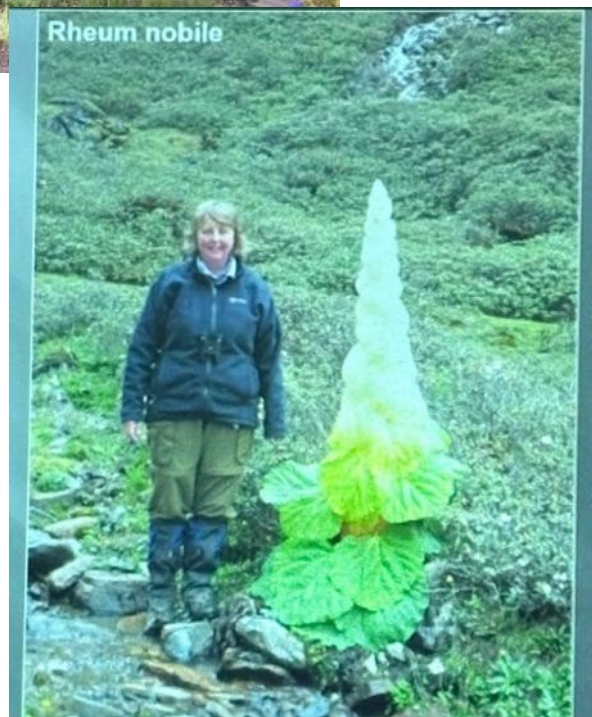

“You
know



it's really
fall
when...”



MESSAGE FROM THE CHAIR

You know its really fall when the days are warm and the nights cool off. You know its really fall when the Colchicum and Sternbergia bloom. You know its really fall when the rain that falls (never enough!) does not instantly evaporate from the soil the next day, Halleluiah! Fall weather can energize us, and it becomes a pleasure to weed, cut things back and consider how our gardens could be better 'next year'!

The Chapter had a wonderful summer of activities:

- We had a strong presence at both North and South Park Master Gardener events, handing out program information and explaining what NARGS was all about.
- I opened my garden to you in July and was grateful for your compliments. Or, we had a delightful morning talking about plants
- In August, Sue Colazzi invited us into her spectacular garden for our annual summer picnic. Great food, interesting raffle prizes and a competitive trough competition. Thank you Sue!
- In September Nancy Knauss hosted a very successful trough building workshop. So many people signed up that we had to split the crowd into Morning and Afternoon, bracketing a nice lunch – thanks to Nancy and you all for contributing delicious food.
- We hosted Kevin Kelly for our September meeting, and he gave an excellent presentation on building a crevice garden and crevice trough.

Following the trough construction, participants took their troughs home. Hopefully by now the baskets have been removed and the troughs rewrapped for curing. They can stay wrapped in plastic for another month. Some of these troughs are destined for the Sale in May.

Upcoming Events:

Our next meeting is **Sunday, October 19** at Beechwood Farms (614 Dorseyville Road (Fox Chapel), 15238. Julia Corden from the UK is this year's speaker, sponsored and travel paid for by NARGS national. She will be giving two talks, the first at Noon: **'The Gardens of Scotland'**. Scotland is well known for its long tradition of rock gardens, and Julia led this year's NARGS June trip to view them.

We will then take a break for refreshments (all are invited to bring them) and the next talk will begin at 2pm: **'Alpines of the World'**. We should get some great ideas of what to try in our own gardens and troughs. Julia has botanized alpine areas all over the world, and she is an energetic and entertaining speaker with immense experience in the wild and remote places of the world. Visitors are welcome, \$15 (or a membership fee)

On Sunday, November 9th, from 3pm-5pm, our 2025 NARGS Allegheny Chapter Banquet will once again be held at St. Joseph Church Hall in Fox Chapel, 342 Dorseyville Road. Please send your RSVP to Sue Warden and your \$30 per person fee to Patty McGuire. See you all soon, Leslie Kaplan, Chair

Aviary Rock Garden Update

Alpine Plants Thrive During Pittsburgh's Dry Summer

Late last fall, Paul Spriggs' gift of "Easy Ten" alpine seeds plus 2 taller varieties were sown in the rock garden at the Aviary. As unfamiliar seedlings appeared, members have been careful to remove only identifiable weeds and leave the



The garden remained green and attractive throughout the drought thanks to the efforts of our member



One new item that needs attention in the garden is a tripping hazard in the pathway where various Belgian blocks have heaved. We are looking for a couple of volunteers to help with walkway repairs this fall before the ground freezes. Let us know if you can help, or simply join us at the garden at 9:00 a.m. October 23 or November 13.

others. The dry summer was helpful in discouraging weeds. We anxiously await the spring of 2026 to identify the new plants when they flower. Two different species of *Aethionema* were among the seeds, and numerous blue-green seedlings are growing vigorously. Single rosettes of medium green ovate leaves have expanded into larger clumps during the summer, but naming them will have to wait for spring. At least three other varieties of mystery seedlings have been spotted. Tiny seedlings of *Erinus alpinus* are scattered across the garden as a result of existing plants self-sowing along with



donated seeds germinating.

throughout the volunteers.

One big rain in September made a huge difference. The *Osmanthus*

remained green and maintained its shape all summer but has now sprouted some colorful stems for fall.





We now have 402 Facebook followers
and 104 Instagram followers!

We have never looked so good!!

Keep gardening with rock garden plants.

The most recent post on the trough workshop saw a spike in comments, likes and shares. The May plant sale was mentioned in the post. Posts with multiple photos do better than single photos. The new hashtag, #chaptermembermonday, posts have gotten a good number of *views* and *likes*. I'd love to post pictures from our chapter members every Monday. The photo does NOT have to be a rock garden....any plant you are growing in a trough, a rock garden, in your landscape or container. Please also name the plant and anything special about the origin or a story, anything you'd like to share about your gardening with others.

Please continue liking, commenting, and sharing the posts to your personal page...this is how we build a larger audience.

Many thanks, Barb

3RD QUARTER EVENTS

JULY 12, 2025 – Tour of Leslie Kaplan's Garden in Point Breeze



The expansive list of plants thriving in this space both in a compact, intensely planted garden and along its street side curb, enriched all who visited that day. This newsletter is short on pictures to show how much it was a trip well worth making. Thank you, Leslie



JULY 26TH AND AUGUST 16TH 2025,

OUTREACH EFFORTS

The Penn State Master Gardeners of Allegheny County hosted a meet and greet *Garden in the Park* in both North and South Parks. A table was setup to let people know about NARGS. Leslie Kaplan volunteered for this outreach event and was supported by several members who table-sat or brought trough gardens for display. Leslie provided flyers about upcoming events and spoke to visitors about our Allegheny Chapter membership.





AUGUST 17, 2025 – Annual Picnic; Plant Auction at Sue Colaizzi's Garden What a choice bit of gardening by a beaming host!

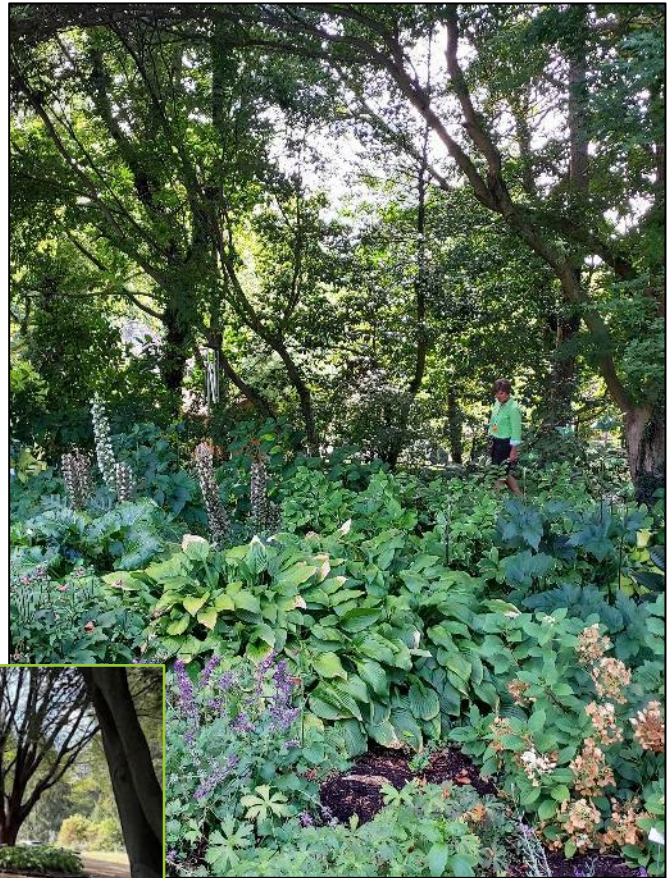

SEPTEMBER - Trough Building for 2026 Plant Sale



Turnout for trough-making was so good they had to work in shifts!

Kevin Kelly's presentation on crevice gardening was enlightening and thoroughly enjoyable; lessons learned from failure became tips for us all

SEPTEMBER 21, 2025-



Creating a Crevice Garden

Kevin Kelly
PennState Extension Master Gardener

Planting a Crevice Garden, Kevin Kelly



How does this work?

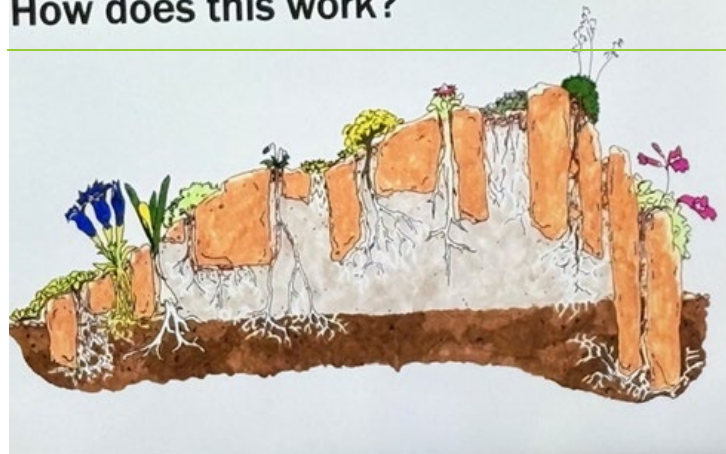

TIP: When planting in temps over 70°F, provide shade from direct sun until plant acclimates.



New Members Update - Welcome



NEW MEMBERS ARE ASKED A FEW QUESTIONS SO WE CAN KNOW THEM A BIT. MARGIE'S ANSWERS ARE BELOW:

Margie Radebaugh

What are some of your favorite plants?

Tree peonies, water lilies, dahlias, spring ephemerals and sweet bay magnolia are just a few plants I love.

Do you have a favorite garden that inspires you?

I am inspired by all gardens and especially public botanic gardens such as

Longwood Gardens, the Morton Arboretum, the Desert Botanic Garden, and, of course, Phipps.

If you could choose anyone as a gardening mentor, who would it be?

I have heard many impressive gardeners speak over the years and have visited many public and private gardens around the United States. I could not pick one person, although Michael Dirr, Alan Armitage, Pamela Harper, Rick Darke and Doug Tallamy have been particularly influential. *Locally, Lynn Purse.*

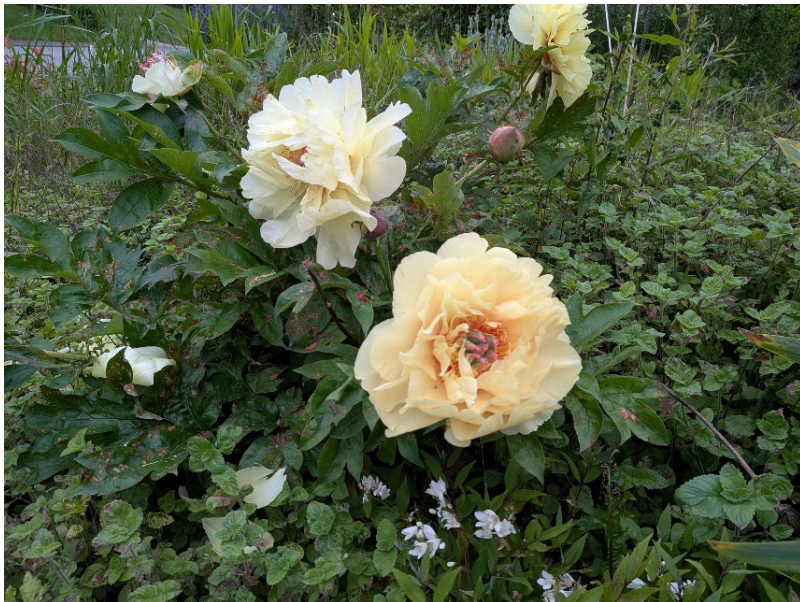
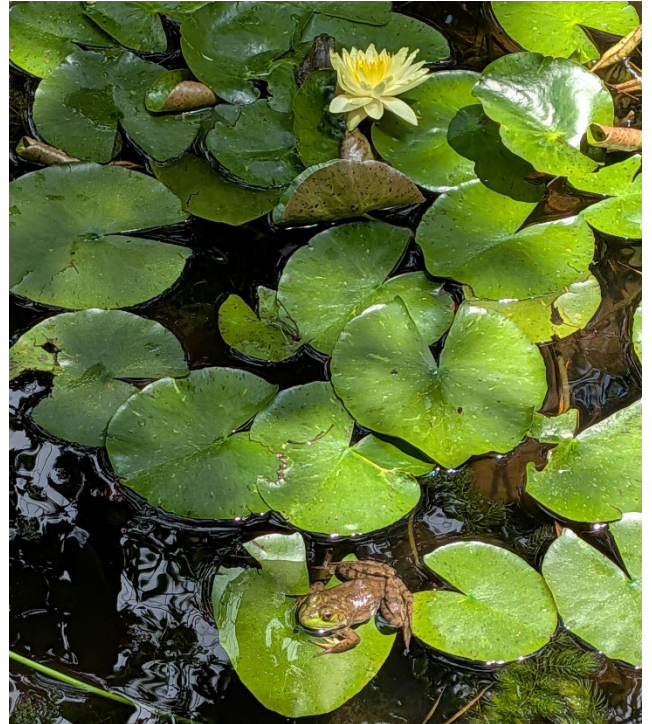

What do you do when you are not gardening? Other hobbies, travel, sports...

I enjoy being outside, biking, hiking, kayaking, walking, cross country skiing, as well as visiting with family and playing with my young granddaughter. I also enjoy reading and going to car cruises, to name just a few things.

Thanks. Margie

Landscape Plants Rated by Deer Resistance

Pedro Perdomo, Morris County Agricultural Agent

Peter Nitzsche, Morris County Agricultural Agent

David Drake, Ph.D., Extension Specialist in Wildlife Management

The following is a list of landscape plants rated according to their resistance to deer damage. The list was compiled with input from nursery and landscape professionals, Cooperative Extension personnel, and Master Gardeners in Northern N.J. Realizing that no plant is deer proof, plants in the *Rarely Damaged*, and *Seldom Rarely Damaged* categories would be best for landscapes prone to deer damage. Plants *Occasionally Severely Damaged* and *Frequently Severely Damaged* are often preferred by deer and should only be planted with additional protection such as the use of fencing, repellents, etc. Success of any of these plants in the landscape will depend on local deer populations and weather conditions.

Latin Name Common Name

ANNUALS

Rarely Damaged

<i>Ageratum houstonianum</i>	Ageratum
<i>Antirrhinum majus</i>	Snapdragon
<i>Brugmansia sp. (Datura)</i>	Angel's Trumpet
<i>Calendula sp.</i>	Pot Marigold
<i>Catharanthus rosea</i>	Annual Vinca
<i>Centaurea cineraria</i>	Dusty Miller
<i>Cleome sp.</i>	Spider Flower
<i>Consolida ambigua</i>	Larkspur
<i>Euphorbia marginata</i>	Snow-on-the-Mountain
<i>Helichrysum</i>	Strawflower
<i>Heliotropium arborescens</i>	Heliotrope
<i>Lobularia maritima</i>	Sweet Alyssum
<i>Matricaria sp.</i>	False Camomile
<i>Myosotis sylvatica</i>	Forget-Me-Not
<i>Nicotiana sp.</i>	Flowering Tobacco
<i>Papaver sp.</i>	Poppy
<i>Pimpinalla anisum</i>	Anise
<i>Rosmarinus officinalis</i>	Rosemary

Seldom Severely Damaged

<i>Anethum graveolens</i>	Dill
<i>Borage officinalis</i>	Borage
<i>Celosia sp.</i>	Cock's Comb
<i>Centaurea cyanus</i>	Bachelor's Buttons
<i>Cheiranthus sp.</i>	Wallflower
<i>Eschscholzia californica</i>	California Poppy
<i>Iberis umbellata</i>	Candytuft
<i>Lantana sp.</i>	Lantana
<i>Lobelia sp.</i>	Lobelia
<i>Matthiola sp.</i>	Stocks
<i>Ocimum basilicum</i>	Basil
<i>Perilla frutescens</i>	Shiso

Latin Name Common Name

<i>Petroselinum crispum</i>	Parsley
<i>Salvia</i>	Salvia
<i>Tagetes patula</i>	French Marigold
<i>Tropaeolum majus</i>	Nasturtium
<i>Verbena x hybrida</i>	Verbena
<i>Zinnia sp.</i>	Zinnia

Occasionally Severely Damaged

<i>Begonia semperflorens</i>	Wax Begonia
<i>Coleus sp.</i>	Coleus
<i>Cosmos sp.</i>	Cosmos
<i>Dahlia sp.</i>	Dahlia
<i>Gerbera jamesonii</i>	Gerbera Daisy
<i>Helianthus sp.</i>	Sunflower
<i>Impatiens balsamina</i>	Balsam, Touch-Me-Not
<i>Impatiens walleriana</i>	Impatiens
<i>Ipomea sp.</i>	Morning Glory
<i>Pelargonium sp.</i>	Geranium
<i>Petunia sp.</i>	Garden Petunia
<i>Viola sp.</i>	Pansy

BIENNIALS

Rarely Damaged

<i>Digitalis purpurea</i>	Common Foxglove
---------------------------	-----------------

Seldom Severely Damaged

<i>Dianthus barbatus</i>	Sweet William
<i>Lunaria annua</i>	Money Plant
<i>Myosotis alpestris</i>	Forget-Me-Not

Occasionally Severely Damaged

<i>Campanula medium</i>	Canterbury Bells
-------------------------	------------------



THE STATE UNIVERSITY OF NEW JERSEY

RUTGERS
COOK COLLEGE

Latin Name	Common Name
BULBS	
Rarely Damaged	
<i>Allium sp.</i>	Ornamental Onion
<i>Colchicum sp.</i>	Autumn Crocus
<i>Endymion sp.</i>	Bluebell
<i>Eranthus hyemalis</i>	Winter Aconite
<i>Fritilaria imperialis</i>	Crown Imperial, Fritilia
<i>Galanthus nivalis</i>	Snowdrops
<i>Narcissus sp.</i>	Daffodil
<i>Scilla siberica</i>	Siberian Squill

Seldom Severely Damaged	
<i>Camassia leichtlini</i>	Camassia
<i>Canna sp.</i>	Canna Lily
<i>Colocasia esculenta</i>	Elephant Ear
<i>Crocus sp.</i>	Crocus
<i>Gladiolus sp.</i>	Gladiolus
<i>Gloriosa superba</i>	Glory Lily
<i>Hyacinthus sp.</i>	Hyacinth
<i>Muscari sp.</i>	Grape Hyacinth
<i>Oxalis sp.</i>	Wood Sorrel
<i>Zantedeschia sp.</i>	Calla Lily

Occasionally Severely Damaged	
<i>Caladium sp.</i>	Caladium
<i>Lilium sp.</i>	Garden Lily

Frequently Severely Damaged	
<i>Tulip sp.</i>	Tulip

FERNS	
Rarely Damaged	
<i>Athyrium goeringianum (nipponicum)</i>	Japanese Painted Fern
<i>Cyrtomium falcatum</i>	Holly Fern
<i>Dennstaedtia punctilobula</i>	Hayscented Fern
<i>Dryopteris marginalis</i>	Wood Fern
<i>Matteuccia struthiopteris</i>	Ostrich Fern
<i>Onoclea sensibilis</i>	Sensitive Fern
<i>Osmunda cinnamomea</i>	Cinnamon Fern
<i>Osmunda regalis</i>	Royal Fern
<i>Polystichum arcostichoides</i>	Christmas Fern
<i>Thelyptens noveboracensis</i>	New York Fern

GROUNDCOVERS	
Rarely Damaged	
<i>Aegopodium podagaria</i>	Bishop's Weed
<i>Ajuga reptans</i>	Bugleweed
<i>Arctostaphylos uva-ursi</i>	Bearberry
<i>Convallaria majalis</i>	Lily of the Valley
<i>Epimediurn sp.</i>	Barrenwort
<i>Galium odoratum (Asperula odorata)</i>	Sweet Woodruff
<i>Lamium sp.</i>	Spotted Deadnettle
<i>Pachysandra procumbens</i>	Allegheny Spurge
<i>Pachysandra terminalis</i>	Pachysandra

Latin Name	Common Name
Seldom Severely Damaged	
<i>Cerastigma plumbaginoides</i>	Plumbago
<i>Gaultheria procumbens</i>	Creeping Wintergreen
<i>Liriope sp.</i>	Lilyturf
<i>Vinca major</i>	Large Periwinkle
<i>Vinca minor</i>	Periwinkle

Occasionally Severely Damaged	
<i>Euonymus fortunei</i>	Wintercreeper
<i>Hedera helix</i>	English Ivy

ORNAMENTAL GRASSES	
Rarely Damaged	
<i>Acorus sp.</i>	Japanese Sweet Flag
<i>Andropogon sp.</i>	Big Bluestem
<i>Arrhenatherum elatius</i>	Varigated Oat Grass
<i>Arundo donax</i>	Giant Reed
<i>Calamagrostis sp.</i>	Feather Reed Grass
<i>Carex sp.</i>	Japanese Sedge
<i>Chasmanthium latifolium</i>	Northern Sea Oats
<i>Cortaderia selloana</i>	Pampus Grass
<i>Eragrostus curvula</i>	Weeping Love Grass
<i>Erianthus ravennae</i>	Ravenna Grass
<i>Fargesia sp.</i>	Clump Bamboo
<i>Festuca glauca</i>	Blue Fescue
<i>Hakonechloa macra</i>	Hakonechloa
<i>Helictotrichon sempervirens</i>	Blue Oat Grass
<i>Imperata cylindrica</i>	Japanese Blood Grass
<i>Juncus Effusus</i>	Hard Rush
<i>Koeleria glauca</i>	Large Blue June Grass
<i>Leymus arenarius glaucous</i>	Lyme Grass
<i>Miscanthus floridulis</i>	Giant Japanese Silver Grass
<i>Miscanthus sinensis</i>	Japanese Silver Grass
<i>Molinia caerulea</i>	Purple Moor Grass
<i>Molinia caerulea 'Variegata'</i>	Variegated Purple Moor Grass
<i>Panicum virgatum</i>	Switch Grass
<i>Pennisetum alopecuroides</i>	Fountain Grass
<i>Pennisetum orientale</i>	Oriental Fountain Grass
<i>Phyllostachys aurea</i>	Golden Bamboo
<i>Schizachyrium scoparium</i>	Little Bluestem
<i>Sorghastrum nutans</i>	Indian Grass

Seldom Severely Damaged	
<i>Bambusa sp.</i>	Bamboo
<i>Carex pendula</i>	Drooping Sedge
<i>Hystrix patula</i>	Bottlebrush Grass
<i>Ophiopogon japonicus</i>	Dwarf Mondo Grass
<i>Phalaris arundinaceae</i>	Ribbon Grass
<i>Scirpus lacustris</i>	Sedge

PERENNIALS	
Rarely Damaged	
<i>Aconitum sp.</i>	Monkshood
<i>Agastache sp.</i>	Anise Hyssop
<i>Allium sp.</i>	Ornamental Onion
<i>Arabis caucasica</i>	Rock-Cress

Latin Name	Common Name
<i>Arisaema triphyllum</i>	Jack-in-the-pulpit
<i>Armoracia rusticana</i>	Horseradish
<i>Artemisia dracunculus</i>	Tarragon
<i>Artemisia sp.</i>	Silver Mound
<i>Asarum canadense</i>	Wild Ginger
<i>Asarum europaeum</i>	European Ginger
<i>Aubretia deltoidea</i>	Purple Rock-Cress
<i>Aurinia saxatilis</i>	Basket of Gold
<i>Baptisia australis</i>	False Indigo
<i>Bruneria macrophylla</i> (<i>Brunnera</i>)	Siberian Bugloss
<i>Cactaceae sp.</i>	Cactus
<i>Coreopsis verticillata</i>	Threadleaf Coreopsis
<i>Corydalis sp.</i>	Corydalis
<i>Dicentra eximia</i>	Fringed Bleeding Heart
<i>Dicentra spectabilis</i>	Bleeding Heart
<i>Echinops ritro</i>	Small Globe Thistle
<i>Euphorbia sp.</i> (except ‘Chameleon’)	Spurge
<i>Helleborus sp.</i>	Lenton or Christmas Rose
<i>Hesperis matronalis</i>	Dame’s Rocket
<i>Hyssopus officinalis</i>	Hyssop
<i>Iris sp.</i> (may eat buds)	Iris
<i>Lavandula sp.</i>	Lavendar
<i>Ligularia dentata</i>	Bigleaf Goldenray
<i>Ligularia ‘The Rocket’</i>	Rocket Ligularia
<i>Limonium latifolium</i>	Statice
<i>Linaria vulgaris</i>	Butter & Eggs
<i>Lychnis coronaria</i>	Rose Campion
<i>Majorana</i>	Marjoram
<i>Marrubium vulgare</i>	Horehound
<i>Melissa officinalis</i>	Lemon Balm
<i>Mentha sp.</i>	Mint
<i>Myosotis sp.</i>	Forget-Me-Not
<i>Nepeta sp.</i>	Catmint
<i>Oreganum sp.</i>	Oregano
<i>Paeonia sp.</i> (may eat buds)	Peony
<i>Perovskio atriplicifolia</i>	Russian Sage
<i>Phlomis sp.</i>	Greek Jerusalem Sage
<i>Podophyllum</i>	May Apple
<i>Potentilla sp.</i>	Potentilla, Cinquefoil
<i>Pulmonaria sp.</i>	Lungwort
<i>Ranunculus sp.</i>	Buttercup
<i>Rodgersia sp.</i>	Rodgers Flower
<i>Ruta sp.</i>	Rue
<i>Salvia officinalis</i>	Garden Sage
<i>Santolina chamaecyparissus</i>	Lavender-Cotton
<i>Stachys byzantina</i>	Lamb’s Ear
<i>Tanacetum vulgare</i>	Common Tansy
<i>Teucrium Chamaedrys</i>	Germander
<i>Thalictrum sp.</i>	Meadow Rue
<i>Thymus sp.</i>	Thyme
<i>Yucca filimentosa</i>	Yucca

Seldom Severely Damaged

<i>Achillea filipendulina</i>	Yarrow
<i>Achillea millefolium</i>	Common Yarrow
<i>Agapanthus sp.</i>	African Lily
<i>Alchemilla sp.</i>	Ladys’ Mantle

Latin Name	Common Name
<i>Anchusa sp.</i>	Bugloss
<i>Anemone x hybrida</i>	Japanese Anemone
<i>Anemonella thalictroides</i>	Rue Anemone
<i>Aquilegia sp.</i>	Columbine
<i>Armeria maritima</i>	Sea Thrift
<i>Asclepias incarnata</i>	Swamp Milkweed
<i>Asclepias tuberosa</i>	Butterfly Weed
<i>Asparagus officinalis</i>	Asparagus
<i>Aster sp.</i>	Aster
<i>Astilbe sp.</i>	Astilbe
<i>Bergenia sp.</i>	Heartleaf Bergenia
<i>Boltonia asteroides</i>	White Boltonia
<i>Cerastium</i>	Snow-in-Summer
<i>Chrysanthemum parthenium</i>	Feverfew
<i>Cimicifuga sp.</i>	Snakeroot, Bugbane
<i>Coreopsis lanceolata</i>	Lance Coreopsis
<i>Crocosmia sp.</i>	Crocosmia
<i>Cyclamen sp.</i>	Cyclamen
<i>Delphinium sp.</i>	Delphinium
<i>Dianthus sp.</i>	Carnation, Pinks
<i>Dictamnus alba</i>	Gas Plant
<i>Digitalis grandiflora</i>	Yellow Foxglove
<i>Echinacea purpurea</i>	Purple Coneflower
<i>Erythronium</i>	Trout Lily
<i>Eupatorium coelestinum</i>	Mist Flower
<i>Eupatorium rugosum</i>	White Snakeroot
<i>Geranium macrorrhizum</i>	Hardy Geranium
<i>Gypsophila sp.</i>	Baby’s Breath
<i>Helenium autumnale</i>	Sneezeweed
<i>Heuchera sp.</i>	Coralbells
<i>Hypericum calycinum</i>	St. John’s Wort
<i>Iberis sempervirens</i>	Candytuft
<i>Kirengeshoma palmata</i>	Yellow Wax-Bells
<i>Kniphofia tritoma</i>	Red-Hot Poker
<i>Liatris sp.</i>	Blazing Star
<i>Lobelia sp.</i>	Cardinal Flower
<i>Lupinus sp.</i>	Lupine
<i>Lychnis chalcidonica</i>	Maltese Cross
<i>Macleaya cordata</i>	Plume Poppy
<i>Mertensia virginica</i>	Virginia Bluebells
<i>Monarda didyma</i>	Beebalm
<i>Papaver orientale</i>	Oriental Poppy
<i>Patrinia scabiosifolia</i>	Patrinia
<i>Physostegia sp.</i>	Obedient Plant
<i>Polemonium caeruleum</i>	Jacob’s Ladder
<i>Primula sp.</i>	Primrose
<i>Rheum rhabarbarum</i>	Rhubarb
<i>Rudbeckia sp.</i>	Black-Eyed Susan
<i>Salvia nemorosa</i>	Meadow Sage
<i>Saponaria sp.</i>	Soapwort
<i>Satureja montana</i>	Savory
<i>Scabiosa caucasica</i>	Pincushin Flower
<i>Sempervivum sp.</i>	Hens and Chickens
<i>Solidago sp.</i>	Goldenrod
<i>Stokesia laevis</i>	Stokes’ Aster
<i>Symplocarpos foetidus</i>	Skunk Cabbage
<i>Tiarella cordifolia</i>	Foam Flower
<i>Tradescantia sp.</i>	Spiderwort
<i>Tricyrtis hirta</i>	Toad Lily

Latin Name	Common Name
<i>Trillium sp.</i>	Trillium
<i>Verbascum sp.</i>	Mullein
<i>Veronica sp.</i>	Speedwell
<i>Viola sp.</i>	Violets

Occasionally Severely Damaged

<i>Alcea sp.</i>	Hollyhock
<i>Aruncus sp.</i>	Goat's Beard
<i>Begonia grandis</i>	Hardy Begonia
<i>Bellis perennis</i>	English Daisy
<i>Campanula glomerata</i>	Bellflower
<i>Centaurea montana</i>	Mountain Bluet
<i>Chelone sp.</i>	Pink Turtlehead
<i>Chrysanthemum</i>	Fall Mums
<i>Chrysanthemum superbum</i>	Shasta Daisy
<i>Erigeron sp.</i>	Fleabane
<i>Euphorbia dulcis</i> 'Chameleon'	Spurge
<i>Filipendula sp.</i>	Meadowsweet
<i>Gaillardia sp.</i>	Blanket Flower
<i>Geranium clarkei</i>	Hardy Geranium
<i>Geranium sanguineum</i>	Hardy Geranium
<i>Geranium x cantabrigiense</i>	Hardy Geranium
<i>Geum sp.</i>	Geum, Avens
<i>Hemerocallis sp.</i>	Daylily
<i>Hibiscus moscheutos</i>	Rose Mallow
<i>Leucanthemum maximum</i>	Shasta Daisy
<i>Lysimachia clethroides</i>	Gooseneck Loosestrife
<i>Lythrum sp.</i>	Purple Loosestrife
<i>Oenothera sp.</i>	Sundrops
<i>Penstemon sp.</i>	Penstemon
<i>Phlox sp.</i>	Phlox
<i>Platycodon grandiflorus</i>	Balloon Flower
<i>Polygonatum sp.</i>	Solomon's Seal
<i>Sedum spectabile</i>	Showy Sedum
<i>Sidalcea malviflora</i>	Checkermallow
<i>Symphytum officinale</i>	Comfrey
<i>Trollius sp.</i>	Globeflower

Frequently Severely Damaged

<i>Eryngium sp.</i>	Sea-Holly
<i>Fragaria sp.</i>	Strawberry
<i>Geranium endressii</i>	Hardy Geranium
<i>Hosta sp.</i>	Hosta
<i>Pardancanda x norrisii</i>	Candy Lily

SHRUBS

Rarely Damaged

<i>Aralia spinosa</i>	Devil's Walking Stick
<i>Berberis sp.</i>	Barberry
<i>Buddleia sp.</i>	Butterfly Bush
<i>Buxus sempervirens</i>	Common Boxwood
<i>Calluna sp.</i>	Heather
<i>Caryopteris clandonensis</i>	Blue Mist Shrub
<i>Cephalotaxus harringtonia</i>	Japanese Plum Yew
<i>Cytisus sp.</i>	Broom
<i>Daphne sp.</i>	Daphne
<i>Elaeagnus angustifolia</i>	Russian Olive

Latin Name	Common Name
<i>Erica sp.</i>	Heath
<i>Ilex x</i> 'John T. Morris'	John T. Morris Holly
<i>Ilex x</i> 'Lydia Morris'	Lydia Morris Holly
<i>Juniperus horizontalis</i> 'Prince of Wales'	Prince of Wales Juniper
<i>Juniperus scopulorum</i> 'Moonglow'	Moonglow Juniper
<i>Leucothoe fontanesiana</i>	Drooping Leucothoe
<i>Mahonia aquifolium</i>	Oregon Grape Holly
<i>Mahonia bealei</i>	Leatherleaf Mahonia
<i>Microbiota decussata</i>	Russian Cypress
<i>Myrica pensylvanica</i>	Bayberry
<i>Pieris floribunda</i>	Mountain Pieris
<i>Pieris japonica</i>	Japanese Pieris, Andromeda
<i>Potentilla fruticosa</i>	Bush Cinquefoil
<i>Rhus aromatica</i>	Fragrant Sumac
<i>Sambucus racemosa</i>	Red Elderberry
<i>Sarcococca hookeriana</i>	Sweet Box
<i>Skimmia japonica</i>	Japanese Skimmia
<i>Viburnum dentatum</i>	Arrowwood Viburnum

Seldom Severely Damaged

<i>Abelia sp.</i>	Glossy Abelia
<i>Abies balsamea</i>	Dwarf Balsam Fir
<i>Andromeda polifolia</i>	Bog Rosemary
<i>Aronia arbutifolia</i>	Red Chokeberry
<i>Aucuba japonica</i>	Goldust Plant
<i>Callicarpa sp.</i>	Beautyberry
<i>Calycanthus floridus</i>	Common Sweetshrub
<i>Calycanthus occidentalis</i>	California Sweetshrub
<i>Chaenomeles japonica</i>	Japanese Flowering Quince
<i>Clerodendrum fargesii</i>	Harlequin Glorybower
<i>Clethra sp.</i>	Sweet Pepperbush
<i>Cornus alba</i>	Red Twigged Dogwood
<i>Cornus sericea</i>	Red Osier Dogwood
<i>Corylus sp.</i>	Hazelnut
<i>Cotinus coggygria</i>	Smokebush
<i>Cotoneaster apiculatus</i>	Cranberry Cotoneaster
<i>Cotoneaster congestus</i>	Pyrenees Cotoneaster
<i>Cotoneaster dammeri</i>	Bearberry Cotoneaster
<i>Cotoneaster horizontalis</i>	Rockspray Cotoneaster
<i>Cotoneaster salicifolius</i>	Willowleaf Cotoneaster
<i>Deutzia sp.</i>	Deutzia
<i>Elaeagnus umbellatus</i>	Autumn Olive
<i>Enkianthus campanulatus</i>	Redvein Enkianthus
<i>Forsythia x intermedia</i>	Forsythia
<i>Fothergilla sp.</i>	Fothergilla
<i>Halesia carolina</i>	Carolina Silverbell
<i>Hamamelis virginiana</i>	Common Witchhazel
<i>Hibiscus syriacus</i>	Rose of Sharon
<i>Hippophae rhamnoides</i>	Sea Buckthorn
<i>Hypericum prolificum</i>	St. John's Wort
<i>Ilex aquifolium</i>	English Holly
<i>Ilex cornuta</i>	Chinese Holly
<i>Ilex glabra</i>	Inkberry
<i>Ilex verticillata</i>	Winterberry Holly
<i>Itea virginica</i>	Virginia Sweetspire
<i>Juniperus chinensis</i> 'Armstrongii'	Armstrong Juniper

Latin Name	Common Name
<i>Juniperus chinensis</i> cv.*	Chinese Juniper
<i>Juniperus chinensis</i> 'Pfitzerana'	Pfitzer Juniper
<i>Juniperus horizontalis</i> cv.*	Creeping Juniper
<i>Juniperus horizontalis</i> 'Youngstown'	Youngstown Andorra Juniper
<i>Juniperus procumbens</i> 'Nana'	Japanese Garden Juniper
<i>Juniperus sabin</i> cv.	Savin/Tam Juniper
<i>Juniperus scopulorum</i> cv.*	Mountain Juniper
<i>Juniperus squamata</i> 'Blue Star'	Blue Star Juniper
<i>Juniperus squamata</i> cv.*	Singleseed Juniper
<i>Kerria japonica</i>	Japanese Kerria
<i>Kolkwitzia amabilis</i>	Beautybush
<i>Lagerstroemia indica</i>	Crape Myrtle
<i>Leucothoe axillaris</i>	Coast Leucothoe
<i>Ligustrum</i> sp.	Privet
<i>Lindera benzoin</i>	Spicebush
<i>Magnolia x soulangiana</i>	Saucer Magnolia
<i>Osmanthus heterophyllus</i>	Holly Osmanthus
<i>Philadelphus coronarius</i>	Sweet Mock Orange
<i>Pinus mugo</i>	Mugo Pine
<i>Prunus laurocerasus</i>	Cherry Laurel
<i>Pyracantha coccinea</i>	Firethorn
<i>Rhamnus</i> sp.	Buckthorn
<i>Ribes</i> sp.	Currant
<i>Rubus</i> sp.	Brambles
<i>Sambucus canadensis</i>	Blueberry Elder, Sweet Elder
<i>Spiraea japonica</i>	Japanese Spirea
<i>Spiraea prunifolia</i>	Bridalwreath Spirea
<i>Spiraea x bumalda</i>	Anthony Waterer Spirea
<i>Symphoricarpos albus</i>	Snowberry
<i>Symphoricarpos x chenaultii</i>	Coralberry
<i>Syringa reticulata</i>	Japanese Tree Lilac
<i>Syringa vulgaris</i>	Common Lilac
<i>Viburnum carlesii</i>	Koreanspice Viburnum
<i>Viburnum opulus</i>	Cranberry Bush
<i>Viburnum plicatum</i> tomentosum	Doublefile Viburnum
<i>Viburnum prunifolium</i>	Blackhaw Viburnum
<i>Viburnum rhytidophyllum</i>	Leatherleaf Viburnum
<i>Viburnum x juddii</i>	Judd Viburnum
<i>Weigela florida</i>	Weigela

Occasionally Severely Damaged

<i>Cornus racemosa</i>	Panicled Dogwood
<i>Cornus sanguinea</i>	Bloodtwig Dogwood
<i>Corylopsis glabrescens</i>	Fragrant Winterhazel
<i>Euonymus alata</i>	Winged Euonymus
<i>Euonymus japonica</i>	Japanese Euonymus
<i>Hydrangea arborescens</i>	Smooth Hydrangea
<i>Hydrangea macrophylla</i>	Bigleaf Hydrangea
<i>Hydrangea paniculata</i>	Panicle Hydrangea
<i>Hydrangea quercifolia</i>	Oakleaf Hydrangea
<i>Ilex crenata</i>	Japanese Holly
<i>Ilex x meserveae</i>	Blue Holly
<i>Juniperus conferta</i>	Shore Juniper
<i>Kalmia latifolia</i>	Mountain Laurel
<i>Nandina</i> sp.	Heavenly Bamboo

Latin Name	Common Name
<i>Prunus x cistena</i>	Purple Leaf Sand Cherry
<i>Rhododendron carolinianum</i>	Carolina Rhododendron
<i>Rhododendron catawbiense</i>	Catawba Rhododendron
<i>Rhododendron maximum</i>	Rosebay Rhododendron
<i>Rhododendron</i> sp.*	Deciduous Azaleas
<i>Rosa multiflora</i>	Multiflora Rose
<i>Rosa rugosa</i>	Rugosa Rose
<i>Rosa x hybrid</i>	Hybrid Tea Rose
<i>Syringa villosa</i>	Late Lilac
<i>Syringa x chinesis</i>	Chinese Lilac
<i>Syringa x persica</i>	Persian Lilac
<i>Vaccinium corymbosum</i>	Highbush Blueberry

Frequently Severely Damaged

<i>Euonymus fortunei</i>	Wintercreeper
<i>Rhododendron penclymenoides</i>	Pinxterbloom Azalea
<i>Rhododendron</i> sp.*	Evergreen Azaleas
<i>Rhododendron</i> sp.*	Rhododendrons
<i>Taxus</i> sp.	Yews

TREES

Rarely Damaged

<i>Aesculus parviflora</i>	Bottlebrush Buckeye
<i>Albizia julibrissin</i>	Mimosa
<i>Asimina triloba</i>	Pawpaw
<i>Betula nigra</i>	River Birch
<i>Betula papyrifera</i>	Paper Birch
<i>Cercidiphyllum japonicum</i>	Katsura Tree
<i>Ilex opaca</i>	American Holly
<i>Picea glauca</i> 'Conica'	Dwarf Alberta Spruce
<i>Pinus resinosa</i>	Red Pine
<i>Pinus rigida</i>	Pitch Pine
<i>Pinus thunbergiana</i>	Japanese Black Pine

Seldom Severely Damaged

<i>Acer griseum</i>	Paperbark Maple
<i>Acer palmatum</i>	Japanese Maple
<i>Acer pensylvanicum</i>	Striped Maple
<i>Acer rubrum</i>	Red Maple
<i>Acer saccharum</i>	Sugar Maple
<i>Aesculus x carnea</i>	Ruby Horsechestnut
<i>Amelanchier arborea</i>	Downy Serviceberry
<i>Amelanchier canadensis</i>	Shadbush
<i>Amelanchier laevis</i>	Allegheny Serviceberry
<i>Betula albo-sinensis</i>	Chinese Paper Birch
<i>Betula jacquemontii</i>	Himalayan Birch
<i>Betula lutea</i>	Yellow Birch
<i>Betula pendula</i>	European White Birch
<i>Chaenomeles speciosa</i>	Common Flowering Quince
<i>Chamaecyparis pisifera</i>	Japanese Falsecypress
<i>Chionanthus retusus</i>	Chinese Fringe Tree
<i>Cornus kousa</i>	Kousa Dogwood
<i>Crataegus laevigata</i>	English Hawthorn
<i>Cryptomeria japonica</i>	Japanese Cedar
<i>Fagus sylvatica</i>	European Beech
<i>Fraxinus pennsylvanica</i>	Green Ash

*Check other rating categories to find additional species or cultivars of this genus.

Latin Name	Common Name
<i>Fraxinus excelsior</i>	European Ash
<i>Gleditsia triacanthos</i>	Honey Locust
<i>Ilex x aquipernyi</i>	Dragon Lady, San Jose Holly
<i>Juniperus virginiana</i>	Eastern Red Cedar
<i>Koelreuteria paniculata</i>	Goldenrain Tree
<i>Liriodendron tulipifera</i>	Tulip Tree
<i>Metasequoia glyptostroboides</i>	Dawn Redwood
<i>Oxydendrum arboreum</i>	Sourwood
<i>Picea abies</i>	Norway Spruce
<i>Picea glauca</i>	White Spruce
<i>Picea omorika</i>	Serbian Spruce
<i>Picea pungens</i>	Colorado Blue Spruce
<i>Pinus densiflora</i>	Japanese Red Pine
<i>Pinus nigra</i>	Austrian Pine
<i>Pinus strobus</i>	Eastern White Pine
<i>Pinus sylvestris</i>	Scotch Pine
<i>Prunus serrulata</i>	Japanese Flowering Cherry
<i>Pseudotsuga menziesii</i>	Douglas Fir
<i>Salix matsudana tortuosa</i>	Corkscrew Willow
<i>Sassafras albidum</i>	Common Sassafras

Occasionally Severely Damaged

<i>Abies balsamea</i>	Balsam Fir
<i>Abies concolor</i>	White Fir
<i>Abies fraseri</i>	Fraser Fir
<i>Acer platanoides</i>	Norway Maple
<i>Acer saccharinum</i>	Silver Maple
<i>Aesculus hippocastanum</i>	Common Horsechestnut
<i>Cedrus atlantica</i>	Atlas Cedar
<i>Cercis canadensis</i>	Eastern Redbud
<i>Chamaecyparis obtusa</i>	Hinoki Cypress
<i>Chamaecyparis thyoides</i>	Atlantic White Cedar
<i>Chionanthus virginicus</i>	White Fringe Tree
<i>Cornus alternifolia</i>	Alternate-Leaved Dogwood
<i>Cornus florida</i>	Flowering Dogwood
<i>Cornus mas</i>	Cornelian Cherry
<i>Cupressocyparis leylandii</i>	Leyland Cypress
<i>Ilex pernyi</i>	Pernyi Holly
<i>Ilex x 'Nellie R. Stevens'</i>	Nellie Stevens Holly
<i>Larix decidua</i>	European Larch
<i>Liquidambar styraciflua</i>	Sweetgum

Latin Name	Common Name
<i>Malus sp.</i>	Apples
<i>Prunus avium</i>	Sweet Cherry
<i>Pyrus calleryana</i>	Callery Pear
<i>Pyrus communis</i>	Common Pear
<i>Quercus alba</i>	White Oak
<i>Quercus prinus</i>	Chestnut Oak
<i>Quercus rubra</i>	Northern Red Oak
<i>Rhus typhina</i>	Staghorn Sumac
<i>Robinia pseudoacacia</i>	Black Locust
<i>Salix sp.*</i>	Willows
<i>Taxodium distichum</i>	Bald Cypress
<i>Thuja plicata</i>	Western Arborvitae
<i>Tilia americana</i>	Basswood
<i>Tilia cordata</i> 'Greenspire'	Greenspire Littleleaf Linden
<i>Tsuga canadensis</i>	Eastern Hemlock
<i>Tsuga caroliniana</i>	Carolina Hemlock

Frequently Severely Damaged

<i>Prunus sp.</i>	Plums
<i>Prunus sp.*</i>	Cherries
<i>Sorbus aucuparia</i>	European Mountain Ash
<i>Thuja occidentalis</i>	American Arborvitae

VINES

Seldom Severely Damaged

<i>Celastrus scandens</i>	American Bittersweet
<i>Jasminum nudiflorum</i>	Winter Jasmine
<i>Wisteria floribunda</i>	Wisteria

Occasionally Severely Damaged

<i>Campsis radicans</i>	Trumpet Creeper
<i>Clematis sp.</i>	Clematis
<i>Hedera helix</i>	English Ivy
<i>Hydrangea anomala petiolaris</i>	Climbing Hydrangea
<i>Lonicera x heckrottii</i>	Goldflame Honeysuckle
<i>Parthenocissus quinifolia</i>	Virginia Creeper

Frequently Severely Damaged

<i>Euonymus fortunei</i>	Wintercreeper
--------------------------	---------------

*Check other rating categories to find additional species or cultivars of this genus.

Special thanks to our cooperators on this project:

Helen Heinrich, Certified Landscape Architect; James Messina, Certified Landscape Architect, Landscape Plus;
Valerie Sudal, Garden Writer, The Newark Star-Ledger; and numerous landscapers, Master Gardeners, and
nurserymen who provided ratings.

© 2004 by Rutgers Cooperative Research & Extension, NJAES, Rutgers, The State University of New Jersey.

Desktop publishing by Rutgers-Cook College Resource Center

Revised: April 2003

**RUTGERS COOPERATIVE RESEARCH & EXTENSION
N.J. AGRICULTURAL EXPERIMENT STATION
RUTGERS, THE STATE UNIVERSITY OF NEW JERSEY
NEW BRUNSWICK**

Distributed in cooperation with U.S. Department of Agriculture in furtherance of the Acts of Congress on May 8 and June 30, 1914. Rutgers Cooperative Extension works in agriculture, family and community health sciences, and 4-H youth development. Dr. Karyn Malinowski, Director of Extension. Rutgers Cooperative Research & Extension provides information and educational services to all people without regard to race, color, national origin, gender, religion, age, disability, political beliefs, sexual orientation, or marital or family status. (Not all prohibited bases apply to all programs.) Rutgers Cooperative Research & Extension is an Equal Opportunity Program Provider and Employer.

OFFICERS

CHAIR

Leslie Kaplan

VICE CHAIR

Marie Tkacik

SPEAKER COORDINATOR

Karen Schmidt

SECRETARY

Joanne Burzese

TREASURER

Patty McGuire

COMMITTEE CHAIRS

AWARDS

Patty McGuire

BANQUET

Sue Warden

FACEBOOK

Barb Kline

LIBRARY

Patty McGuire

MEMBERSHIP& PROOFREADER

Lyn Lang

NEWSLETTER EDITOR

Marie Tkacik

PHOTOGRAPHY EXHIBIT

Sue Colaizzi

PLANT SHOW

Michele Newton

PLANT SALE

Nancy Knauss

PROPAGATION

Bill Barnes

SEED EXCHANGE

Patty McGuire

WEBMASTER

Lyn Lang

NARGS ALLEGHENY CHAPTER ROCK GARDEN

The NARGS, Allegheny Chapter rock garden occupies a space next to the National Aviary on Pittsburgh's North Side. Members usually work at the garden the 2nd and 4th Thursdays from 10 a.m. to noon.

